

LOCK SEAM HAMMER

Lighter and neater, more uniform than seamed by hand
 Application of ductwork, tubes, doors, panels etc.
 Lock seam guide can be removed for chisel use
 Used to fold over or seam metal to 16 gauge
 Designed to close the Pittsburgh lock seam
 Reduce the working time up to 80%

FOR YOUR INQUIRIES, PLEASE
 INDICATE MODEL NO., AND
 CATALOGUE NUMBER

SPT298

Pistol Grip Type- Vibro-reduced

Vibration at 6.31m/sec²



Model:
PT33156J2
PT33156J4

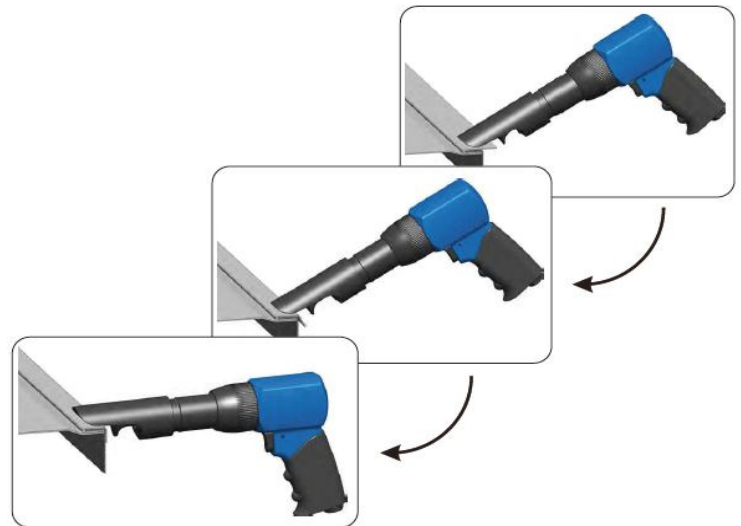

Straight Type

Vibration at 20m/sec²



Model:
PT33156J6
PT33156J8

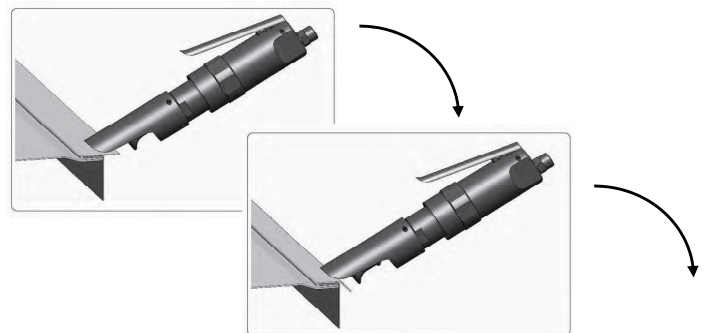

Model No.	Chisel Shank mm (inch) Round	Blows Per Minute	Piston Stroke mm (inch)	Piston Dia. mm	Max. Air Consumption CFM (LPM)	Overall Length mm (inch)	Weight Kg
PT33156J2	10.2 (0.401")	4,200	41 (1.6")	19 x 42	6.2 (176)	260 (10.2")	2.2
PT33156J4	10.2 (0.401")	3,000	66 (2.6")	19 x 48	7.8 (221)	291 (11.5")	2.4
PT33156J6	10.2 (0.401")	4,200	53.5 (2.1")	19 x 31.5	4.8 (136)	272 (10.7")	2.3
PT33156J8	10.2 (0.401")	4,666	38.5 (1.5")	25.4 x 44	6 (170)	301 (11.9")	2.4



20170929 TY



HIMOUNT INDUSTRIAL CO., LTD.
 7TH FL. No.325, FU HSING N. ROAD.
 TAIPEI, TAIWAN
 TEL: 886-2-27135577 886-2-27188886
 FAX: 886-2-27152218
<http://www.himount.com/>
 E-MAIL: info@himount.com