

FOR YOUR INQUIRIES, PLEASE  
INDICATE MODEL NO., AND  
CATALOGUE NUMBER  
**SPT319**

# Angle Impact Wrench



## COMPACT SIZE

- Easy to work in confined areas

## CENTRAL EXHAUST

- 360° rotating exhaust to direct air away from user

## POWERFUL TORQUE

- The gearless mechanism for direct drive transmission

**Breakaway Torque  
680 Nm (500 ft-lb)**

## FEATHER THROTTLE

- For precise control of needed torque

## ROTATING F/R RING

- Easier and quicker control F/R in 2 speed settings

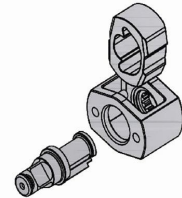

**Jumbo Hammer**

Item No.	Square Drive	Speed	Working Torque		Max. Torque		Avg. Air Consumption	Length
<b>PT372902</b>	3/8"	9500 rpm	180 ft-lb	244 Nm	310 ft-lb	420 Nm	4.5 cfm 127 i/min	9.7 in 247 mm
<b>PT521902</b>	1/2"	9500 rpm	180 ft-lb	244 Nm	310 ft-lb	420 Nm	4.5 cfm 127 i/min	9.7 in 247 mm



20181018/si

HIMOUNT INDUSTRIAL CO., LTD.  
7TH FL. No.325, FU HSING N. ROAD, TAIPEI, TAIWAN  
TEL: 886-2-27135577 886-2-27188886  
FAX : 886-2-27152218  
<http://www.himount.com/>  
E - MAIL: info@himount.com