

PRODUCT INFORMATION

FOR YOUR INQUIRIES, PLEASE
INDICATE MODEL NO. AND FOLLOWING
CATALOGUE NUMBER

STV051

HEAVY DUTY OCTAGONAL SUPPORTING VISE

Features:

- Material: FCD55 (65000 psi)
- Support Rod use octagonal circumference pipe
- Fully enclosed spindle and guide screw nut
- 360° swivel base with gear device

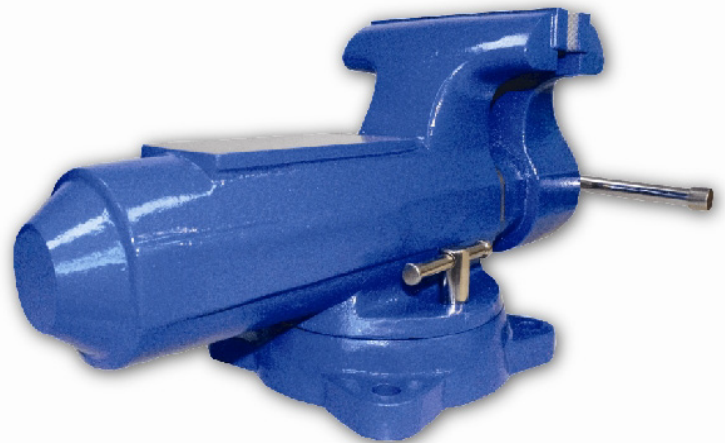
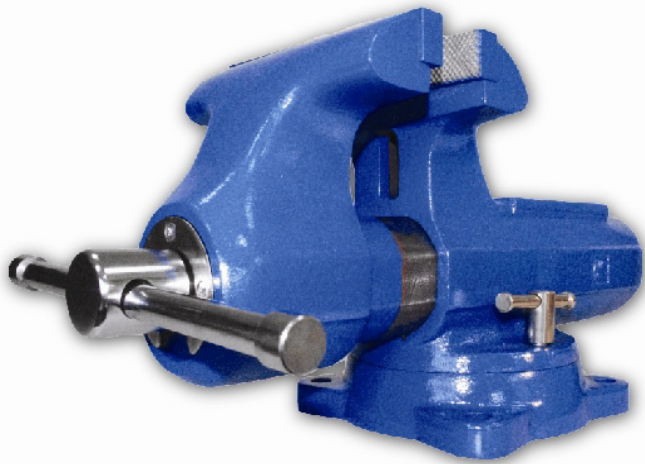

Model No.	Jaw Width	Jaw Opening	Jaw Depth	N.W.
TV12002	5" (125mm)	6" (150mm)	3-1/2" (88mm)	23kg
TV12004	6" (150mm)	8" (200mm)	3-3/4" (95mm)	27kg
TV12006	8" (200 mm)	9" (225 mm)	4-1/2" (114 mm)	40.5kg



HIMOUNT INDUSTRIAL CO., LTD.

7TH FL. No.325, FU HSING N. ROAD.

TAIPEI, TAIWAN

TEL: 886-2-27135577 FAX: 886-2-27152218

E - MAIL : info@himount.com

[http:// www.himount.com](http://www.himount.com)